

# Pima Center Phase III Flex/Industrial

## Scottsdale, Arizona 85258

North Scottsdale Address!  
Delivering Q3 2017!



### PROPERTY FEATURES

- ±151,728 Total SF
- Building A: ±70,296 SF Floorplate + Mezzanine
- Building B: ±70,296 SF Floorplate + Mezzanine
- ±9,810 SF Minimum Divisibility
- 160' Fully Secured Truck Court
- 24' Clear Height
- 3,000a 277/480v Per Building
- 2.5:1000 Parking (Expandable)
- Loading: 20 Truck Well, 12 Grade Level

### ADDITIONAL FEATURES

- R-30 Insulation
- LED Warehouse Lighting
- Customized Cooling Options:  
Full HVAC, EVAP Cooling, or High  
Volume/Low Speed Fans
- Attractive Upgraded Architectural Exterior
- Tinted Glazing and Performance Glass
- Conceptual "Green Space" Courtyard  
Feature for Large End-Cap Suites



DEVELOPED BY



For more information, please contact:

**CURTIS BROWN**  
480.362.9501

cbrown@rossbrown.com

**SHAWN DOOLEY**  
480.362.9526

sdooley@rossbrown.com

**KYLE MCGINLEY**  
480.362.9507

kmcginley@rossbrown.com

8925 East Pima Center Parkway, Suite 200  
Scottsdale, Arizona 85258  
www.RossBrown.com

**ROSS  
BROWN**

# Pima Center Phase III Flex/Industrial

## Scottsdale, Arizona 85258

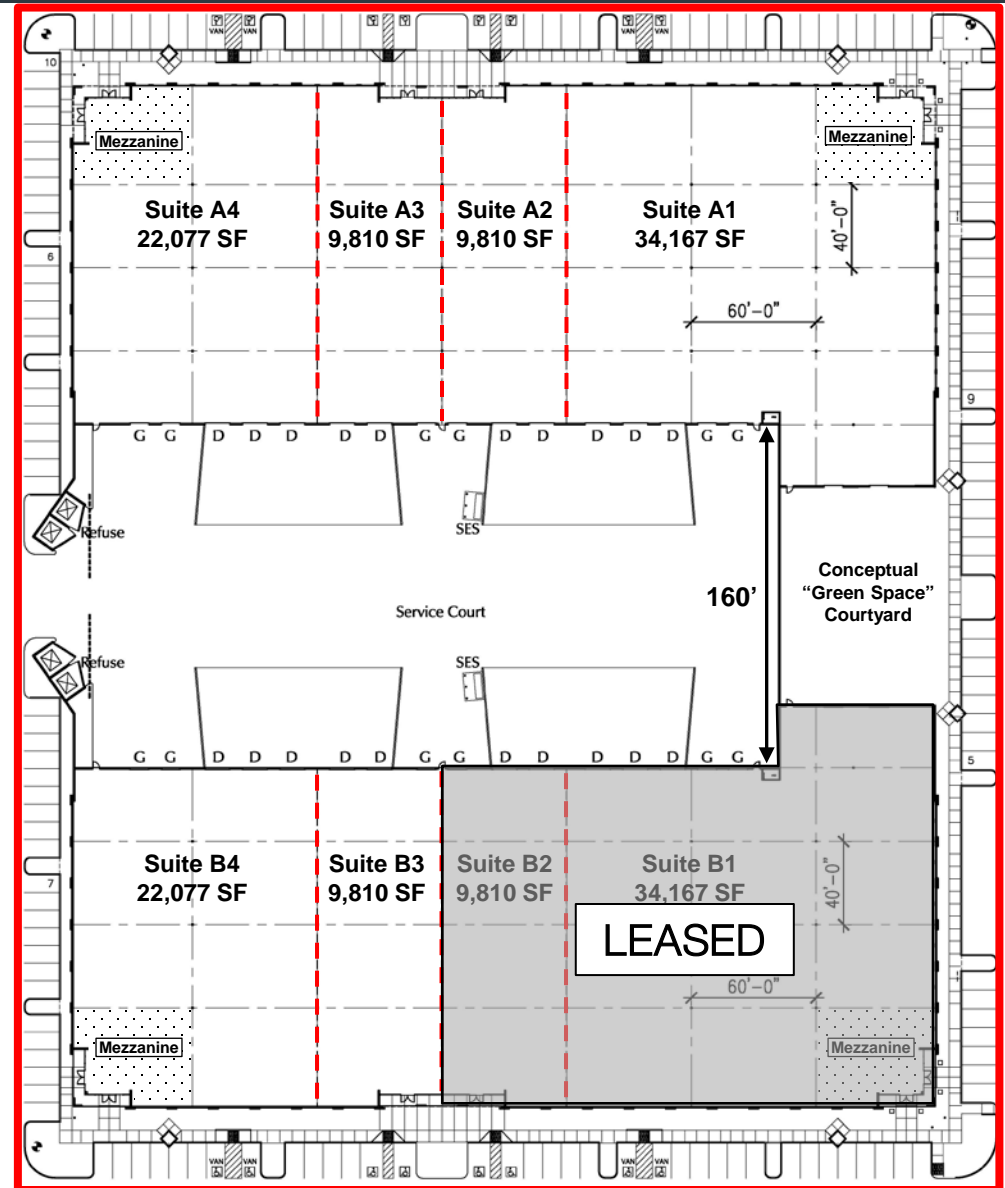
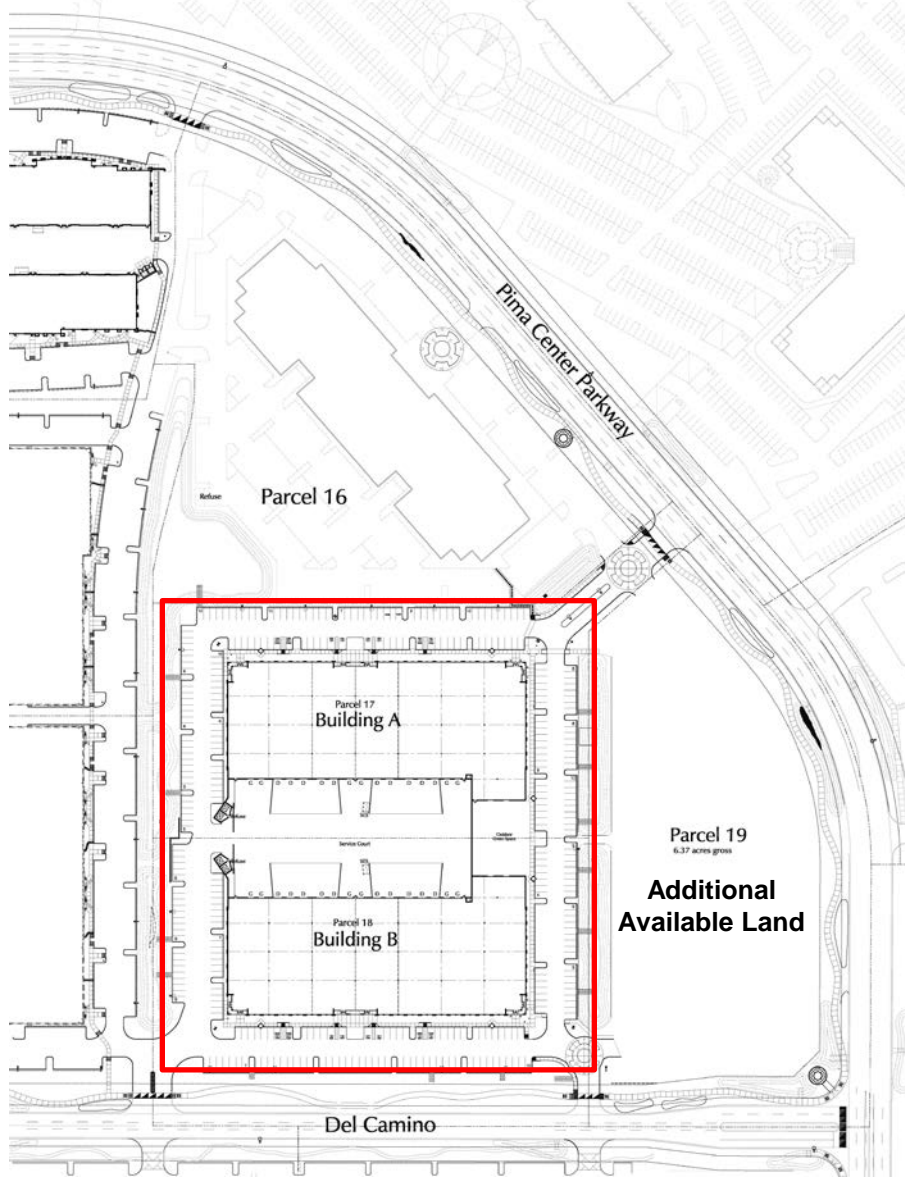

DEVELOPED BY



For more information, please contact:

**CURTIS BROWN**  
480.362.9501

cbrown@rossbrown.com

**SHAWN DOOLEY**  
480.362.9526

sdooley@rossbrown.com

**KYLE MCGINLEY**  
480.362.9507

kmcginley@rossbrown.com

8925 East Pima Center Parkway, Suite 200  
Scottsdale, Arizona 85258  
www.RossBrown.com

**ROSS  
BROWN**